

SERIES 7 SHELL REAMERS

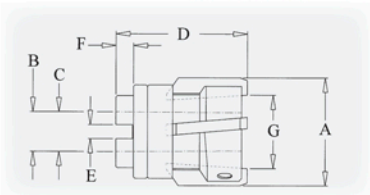

TYPE OF REAMER	TYPE OF REAMER	SIZE OF REAMER A	SIZE OF HOLE LARGE END B	LARGEST SIZE STRAIGHT HOLE C	LENGTH OVERALL D	WIDTH LENGHT KEYWAY E & F	DIST. BETWEEN BLADES G	DIST. BETWEEN BLADES G	ADJUSTM. OVER SIZE	ADJUSTM. OVER SIZE	BLADES PER REAMER & THICKNESS	BLADES PER REAMER & THICKNESS	DIMENSION OF CARBIDE TIP
7-B-6	R7-B-6	1.250-1.343	3/8	7/16	2 15/16	3/16	.832	.772	.120	.120	6-.120	6-.100	1/32 x 3/16 x 3/4
7-C-6	R7-C-6	1.375-1.593	1/2	9/16	2 15/16	1/4	.926	.834	.120	.120	6-.120	6-.100	1/32 x 3/16 x 3/4
7-D-6	R7-D-6	1.625-1.843	5/8	11/16	2 15/16	1/4	1.082	1.084	.120	.120	6-.120	6-.120	1/32 x 3/16 x 3/4
7-E-6	R7-E-6	1.875-2.093	3/4	13/16	2 15/16	5/16	1.207	1.209	.130	.130	6-.200	6-.120	1/16 x 1/4 x 1
7-F-6	R7-F-6	2.125-2.406	7/8	1	2 15/16	5/16	1.395	1.397	.130	.130	6-.200	6-.200	1/16 x 1/4 x 1
7-G-6	R7-G-6	2.437-2.718	1	1 1/8	3 1/16	3/8	1.520	1.522	.130	.130	6-.250	6-.200	1/16 x 1/4 x 1
7-H-6	R7-H-6	2.750-3.031	1 1/4	1 3/8	3 1/16	3/8	1.770	1.772	.130	.130	6-.250	6-.250	1/16 x 1/4 x 1
7-I-8	R7-I-8	3.062-3.531	1 3/8	1 9/16	3 1/16	3/8	1.956	1.958	.130	.130	8-.250	8-.250	1/16 x 1/4 x 1
7-J-8	R7-J-8	3.562-4.031	1 3/4	1 7/8	3 1/16	1/2	2.270	2.272	.130	.130	8-.250	8-.250	1/16 x 1/4 x 1
7-K-10	R7-K-10	4.062-4.531	2	2 1/8	3 1/16	1/2	2.784	2.785	.230	.230	10-.250	10-.250	1/16 x 1/4 x 1
7-L-10	R7-L-10	4.562-5.031	2 1/4	2 5/8	3 1/16	1/2	3.284	3.285	.230	.230	10-.250	10-.250	1/16 x 1/4 x 1
7-M-12	R7-M-12	5.062-5.531	2 1/2	3 1/8	3 1/16	5/8	3.784	3.785	.230	.230	12-.250	12-.250	1/16 x 1/4 x 1
7-N-12	R7-N-12	5.562-6.000	2 3/4	3 5/8	3 1/16	5/8	4.284	4.285	.230	.230	12-.250	12-.250	1/16 x 1/4 x 1

DIMENSIONS ARE IN INCHES